

Basic Bearing No.	A	BC	DX	DD	EE	EX	F	G	H	J	Cap No.	K	Cap No.	L	M	Cap No.	N	O	Cap No.	P	R	Cap No.	S	T	Cap No.	U	V	Cap No.
200	2 3/8	1 1/8	1.187	1 1/8	.115	.055	7/16	1/4	1/4	4	HA00	1 1/8	JA00	1 1/8	1/2	KA00	.999	1 1/8	LA00	1 1/8	.999	MA00	1 1/8	.500	PA00	3/4	.312	RA00
201	2 1/2	1 7/8	1.265	1 1/2	.115	.055	7/16	1/4	1/4	4	HA01	1 1/8	JA01	3/4	9/16	KA01	1.124	1 1/8	LA01	1	1.124	MA01	1/2	.625	PA01	13/16	.406	RA01
202	2 5/8	2	1.383	1 13/16	.115	.055	7/16	1/4	1/4	4	HA02	1 1/4	JA02	3/4	9/16	KA02	1.124	1 1/8	LA02	1	.999	MA02	1/2	.562	PA02	13/16	.500	RA02
203	2 3/4	2 1/8	1.580	1 13/16	.115	.055	7/16	1/4	1/4	4	HA03	1 1/2	JA03	3/4	9/16	KA03	1.250	1 1/8	LA03	1	1.250	MA03	1/2	.625	PA03	13/16	.406	RA03
204	3 1/8	2 1/2	1.856	2 1/8	.131	.055	7/16	1/4	1/4	4	HA04	1 5/8	JA04	13/16	5/8	KA04	1.499	1 1/8	LA04	1 1/8	1.375	MA04	9/16	.875	PA04	7/8	.562	RA04
205	3 3/8	2 5/8	2.053	2 5/8	.131	.055	7/16	1/4	1/4	4	HA05	1 7/8	JA05	7/8	1 1/16	KA05	1.828	1 1/8	LA05	1 3/8	1.499	MA05	5/8	1.125	PA05	15/16	.875	RA05
206	3 3/4	3 1/8	2.446	2 23/32	.184	.078	9/16	3/8	3/8	4	HA06	2 3/16	JA06	7/8	7/8	KA06	2.125	7/8	LA06	1 3/8	1.752	MA06	1 1/8	1.250	PA06	1 3/8	1.062	RA06
207	4 1/8	3 1/2	2.840	3 5/8	.184	.078	9/16	3/8	3/8	4	HA07	2 5/8	JA07	7/8	7/8	KA07	2.374	15/16	LA07	1 3/4	2.000	MA07	1 1/8	1.625	PA07	1 3/8	1.062	RA07
208	4 7/8	4	3.155	3 1/2	.184	.078	9/16	3/8	3/8	4	HA08	2 7/8	JA08	1 1/8	15/16	KA08	2.623	15/16	LA08	1 1/2	2.250	MA08	1 1/8	1.812	PA08	1 1/4	1.437	RA08
209	5	4 1/8	3.352	3 11/16	.184	.078	9/16	3/8	3/8	4	HA09	3 1/16	JA09	1 1/8	15/16	KA09	2.875	15/16	LA09	1 1/2	2.502	MA09	1 1/8	2.000	PA09	1 1/4	1.687	RA09
210	5 1/4	4 9/8	3.549	3 7/8	.214	.108	9/16	3/8	3/8	4	HA10	3 1/4	JA10	1 3/8	1	KA10	3.000	15/16	LA10	1 3/4	2.750	MA10	1 3/8	2.187	PA10	1 1/2	1.875	RA10
211	6	4 7/8	3.943	4 9/16	.214	.108	9/16	3/8	3/8	4	HA11	3 9/16	JA11	1 3/8	1 1/8	KA11	3.350	1 1/8	LA11	1 11/16	3.000	MA11	1	2.437	PA11	1 5/8	2.062	RA11
212	6 3/8	5 1/4	4.337	4 21/32	.214	.108	9/16	3/8	3/8	4	HA12	4	JA12	1 3/8	1 1/8	KA12	3.751	1 1/8	LA12	1 11/16	2.502	MA12	1	2.625	PA12	1 5/8	2.187	RA12
213	6 7/8	5 3/4	4.730	5 3/16	.259	.122	3/4	1/2	1/2	4	HA13	4 1/4	JA13	1 5/8	1 3/8	KA13	4.003	1 1/8	LA13	1 15/16	3.500	MA13	1	2.937	PA13	1 7/8	2.437	RA13
214	7 1/8	6	4.927	5 3/8	.259	.122	3/4	1/2	1/2	4	HA14	4 1/2	JA14	1 5/8	1 3/8	KA14	4.249	1 3/8	LA14	1 15/16	3.751	MA14	1 1/8	3.125	PA14	1 7/8	2.625	RA14
215	7 1/4	6 1/8	5.124	5 19/32	.259	.122	3/4	1/2	1/2	4	HA15	4 3/4	JA15	1 5/8	1 3/8	KA15	4.376	1 3/8	LA15	1 15/16	3.256	MA15	1 1/8	3.312	PA15	1 7/8	2.750	RA15
216	7 5/8	6 1/2	5.517	5 31/32	.290	.122	3/4	1/2	1/2	6	HA16	5	JA16	1 5/8	1 3/8	KA16	4.626	1 3/8	LA16	1 15/16	4.125	MA16	1 1/8	3.562	PA16	1 15/8	3.000	RA16
217	8 1/8	7	5.912	6 3/8	.290	.122	3/4	1/2	1/2	6	HA17	5 1/2	JA17	1 5/8	1 3/8	KA17	4.751	1 3/8	LA17	1 15/16	4.125	MA17	1 1/8	3.750	PA17	1 15/8	2.437	RA17
218	8 3/4	7 1/2	6.305	6 3/4	.290	.122	3/4	1/2	1/2	6	HA18	5 3/4	JA18	1 3/4	1 3/8	KA18	4.999	1 3/8	LA18	2 1/16	4.501	MA18	1 1/8	3.937	PA18	1 1/8	3.312	RA18
315																												

\* Replacements may be ordered from Design Aids.  
 \*\* Press fit for all standard seals.  
 \*\*\* Counterbored for socket cap screws may be ordered with 1/16 deep spot face for hex head screw of same size by addition of suffix letters S F to catalogue no.  
 Copyright 1995 The Design Aids Co. Bulletin No. 1205

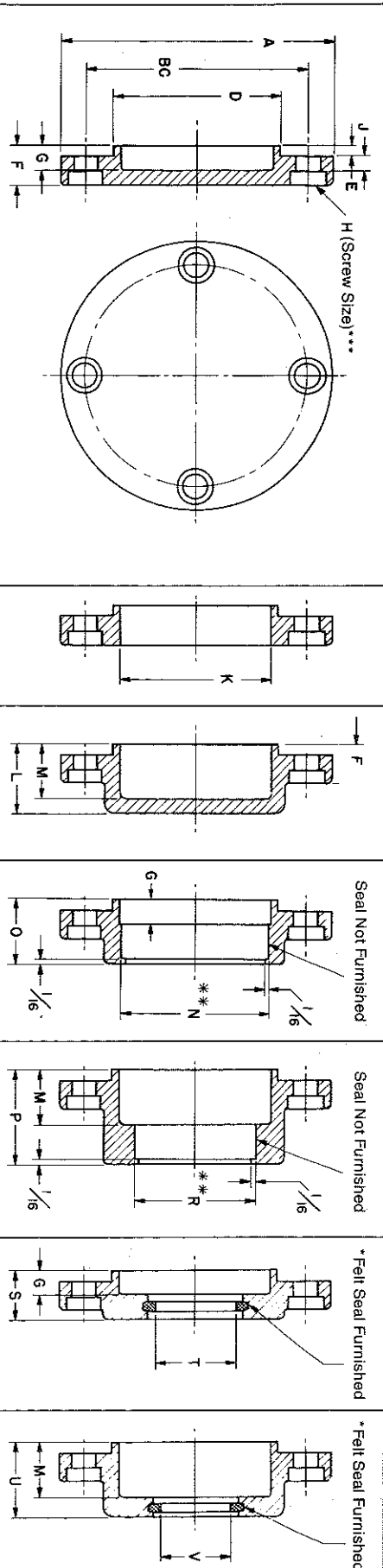

Basic Bearing No.	A	BC	D	E	F	G	H		J	Cap No.	K	Cap No.	L	M	Cap No.	N	O	Cap No.	P	R	Cap No.	S	T	Cap No.	U	V	Cap No.
							Size	No.																			
200	2 3/8	1 3/4	1.179	.130	7/16	1/4	1/4	4	3/16	AA00	1 1/16	EA00	1/2	.500	FA00	3/4	.312	GA00									
201	2 1/2	1 7/8	1.258	.130	7/16	1/4	1/4	4	3/16	AA01	1 1/8	EA01	1/2	.625	FA01	19/16	.406	GA01									
202	2 5/8	2	1.376	.130	7/16	1/4	1/4	4	3/16	AA02	1 1/4	EA02	1/2	.687	FA02	19/16	.500	GA02									
203	2 3/4	2 1/4	1.573	.130	7/16	1/4	1/4	4	3/16	AA03	1 3/8	EA03	1/2	.875	FA03	19/16	.406	GA03									
204	3 1/8	2 1/2	1.848	.130	1/2	5/16	5/16	4	3/16	AA04	1 5/8	EA04	3/8	.937	FA04	7/8	.718	GA04									
205	3 3/8	2 3/4	2.045	.130	1/2	5/16	5/16	4	3/16	AA05	1 7/8	EA05	5/8	1.000	FA05	15/16	.875	GA05									
206	3 3/4	3 1/8	2.439	.130	9/16	3/8	3/8	4	1/4	AA06	2 3/16	EA06	11/16	1.250	FA06	1 3/16	1.062	GA06									
207	4 1/8	3 1/2	2.833	.130	9/16	3/8	3/8	4	1/4	AA07	2 5/8	EA07	1 1/8	1.625	FA07	1 3/8	1.250	GA07									
208	4 7/8	4	3.148	.130	9/16	3/8	3/8	4	3/16	AA08	2 7/8	EA08	1 1/8	1.812	FA08	1 1/4	1.437	GA08									
209	5	4 1/8	3.344	.130	9/16	3/8	3/8	4	3/16	AA09	3 1/8	EA09	1 1/2	1.687	FA09	1 1/4	1.250	GA09									
210	5 1/4	4 3/8	3.541	.130	9/16	3/8	3/8	4	3/16	AA10	3 1/4	EA10	1 3/8	2.750	FA10	1 1/2	1.875	GA10									
211	6	4 7/8	3.985	.193	3/4	1/2	1/2	4	1/4	AA11	3 5/8	EA11	1 1/2	3.000	FA11	1 3/8	2.062	GA11									
212	6 3/8	5 1/4	4.329	.193	3/4	1/2	1/2	4	1/4	AA12	4	EA12	1 1/2	3.751	FA12	1 3/8	2.187	GA12									
213	6 7/8	5 3/4	4.722	.193	3/4	1/2	1/2	4	1/4	AA13	4 1/4	EA13	1 5/8	3.500	FA13	1 3/8	2.437	GA13									
214	7 1/8	6	4.919	.193	3/4	1/2	1/2	4	1/4	AA14	4 1/2	EA14	1 5/8	3.751	FA14	1 3/8	2.625	GA14									
215	7 1/4	6 1/8	5.116	.193	3/4	1/2	1/2	4	1/4	AA15	4 3/4	EA15	1 5/8	3.751	FA15	1 3/8	2.750	GA15									
216	7 3/8	6 1/2	5.510	.193	3/4	1/2	1/2	6	1/4	AA16	5	EA16	1 5/8	4.125	FA16	1 3/8	3.000	GA16									
217	8 1/8	7	5.903	.193	3/4	1/2	1/2	6	1/4	AA17	5 1/2	EA17	1 5/8	4.125	FA17	1 3/8	2.437	GA17									
218	8 3/4	7 1/2	6.297	.255	7/8	5/8	5/8	6	1/4	AA18	5 3/4	EA18	1 5/8	4.501	FA18	1 3/8	2.625	GA18									

Some caps in shaded areas may not be available or may be available at a special price only. Consult factory.

Standard caps are made of cast iron but can be furnished in other materials when required.

Notes: Styles 'D', 'E', 'L' and 'M' caps can sometimes be furnished with 'N' and 'R' seal bores machined to dimensions other than shown, where your seal choice requires it. Consult with factory.

**Design Aids**  
 805 Summerfield Avenue  
 Asbury Park, New Jersey  
 07712 USA

908.528.6292 tel  
 908.528.9771 fax

Our bearing caps are machined on computerized equipment. We provide quality products and eliminate your expense of designing, detailing, checking, pattern-making and machining.

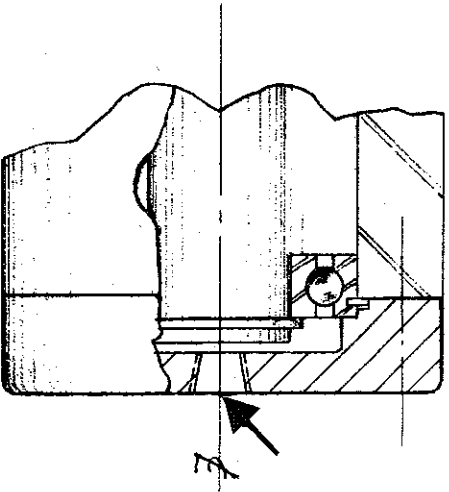

1/8 pipe thread is available on all closed end bearing caps.  
 (Styles A, C, H, K)

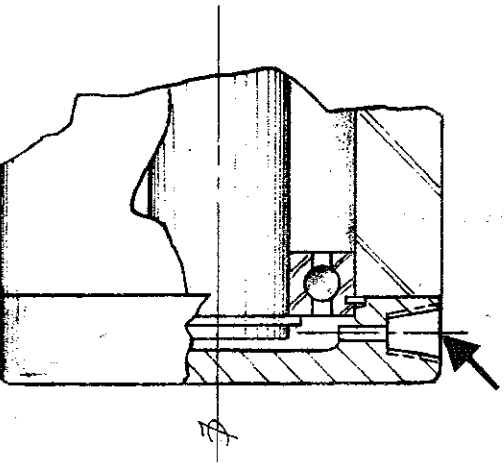

1/8 pipe thread is available on all bearing caps where flange thickness equals or exceeds 9/16 inch.

**Sample Order with Grease Fitting**

- (12) HA05 - 1/8 N.P.T. on flange bearing cap.
- (12) KA07 - 1/8 N.P.T. on wall bearing cap.
- (12) JA00 - 1/4 N.P.T. on flange bearing cap.

"C" (.242) drill hole (P.F. for push-type grease fitting) is available on all bearing caps (flange or wall).

**Note:**

Unless otherwise specified, the grease fittings will be centrally located between two mounting holes.

The lubrication hole is provided at a slight additional cost.

**Metric Fasteners**

All bearing caps can be drilled and counterbored for metric socket cap screws. To order, add the letter "M" after the catalog number.

The conversion table below shows the metric screw alternatives. American standard screws are in column "H" of this brochure.

	American	Metric
	1/4	M 6
	5/16	M 8
	3/8	M10
	1/2	M12
	5/8	M16